

Railroad Museum

OUTDOOR EXHIBITION AND FACILITIES

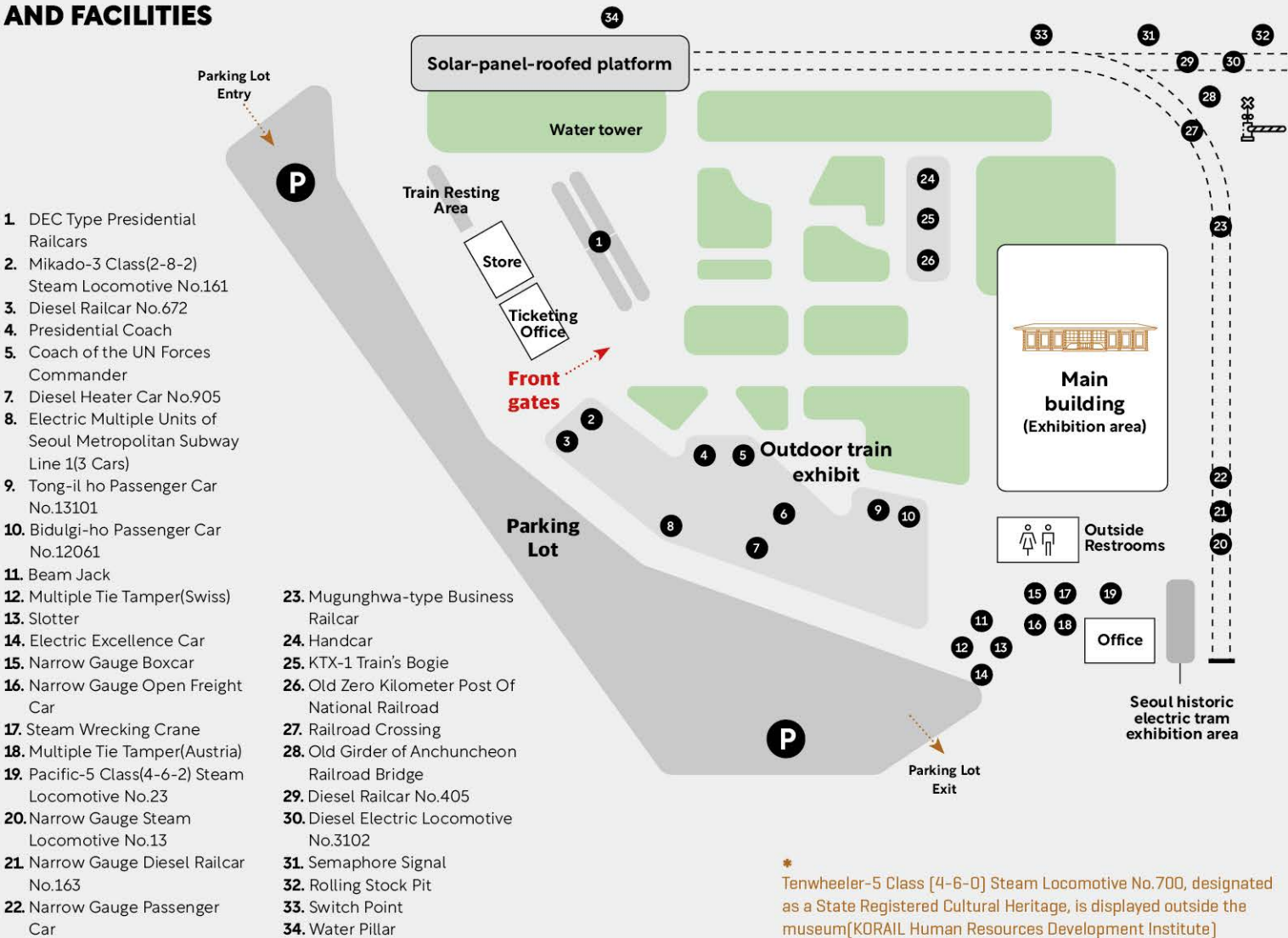

Main Exhibition Vehicles



DEC Type Presidential Railcars
(State Registered Cultural Heritage)



Pacific-5 Class(4-6-2) Steam Locomotive No.23
(State Registered Cultural Heritage)



Presidential Coach
(State Registered Cultural Heritage)



Coach of the UN Forces Commander
(State Registered Cultural Heritage)

VISITOR INFORMATION

Opening Hours

- Summer Season(March to October) : 09:30~17:30
- Winter Season(November to February) : 09:30~17:00

※ Ticket sales end 30 minutes before closing time.

Admission Fees

Category	Individual	Group
Ages 19 to 64	4,000 KRW	2,000 KRW
Ages 4 to 18	2,000 KRW	1,000 KRW

※ Group rates apply to groups of 20 or more people, with different rates for adults and children/youth.

※ Free Admission

- Children under 4 years old(under 48 months)

Closed Days

- Every Monday(open if it falls on a public holiday)
- The day after a public holiday(open if it falls on a weekend)
- New Year's Day(January 1), Lunar New Year, and Chuseok holidays
- Other days designated by the museum director

Directions

• SUBWAY

Take Subway Line 1[Gyeongbu Line] to Uiwang Station. Exit through Exit 2 and walk 10 minutes to the right or Take a bus from the left bus stop.

• BUS

From Exit 2 of Uiwang Station, take bus numbers 1-1, 1-2, 1-5, or 5. Get off at the Korea National University of Transportation and walk for 3 minutes.

• CAR

Navigation 142 Cheoldobakmulgwan-ro, Uiwang-si, Gyeonggi-do [Woram-dong 374-1]

Exit left from the Bugok IC on the Yeongdong Expressway towards Uiwang Station and the Railroad Museum.

RAILROAD
MUSEUM
INTRODUCTION



The Railroad Museum was established to commemorate over 120years of railway history since the beginning of Korea’s railways in 1899. It serves as a cultural space that preserves and exhibits various historical railway artifacts, including actual railway vehicles that played a crucial role in passenger and freight transportation.

HISTORY

●	●	●	●	●	●
1935. 10. 1.	1950. 6.	1981. 10. 15.	1988. 1. 26.	1997. 4. 1.	2003. 12.
Railroad Museum opened [Yongsan Railroad Workers Training Center]	Closed due to the outbreak of the Korean War	Railroad Memorial Hall opened (within the Railroad High School training center)	New Railroad Museum(Bugok Branch) opened	Seoul Branch of Railroad Museum opened	Seoul Branch integrated into Bugok Branch

EXHIBITION
GUIDE

1F

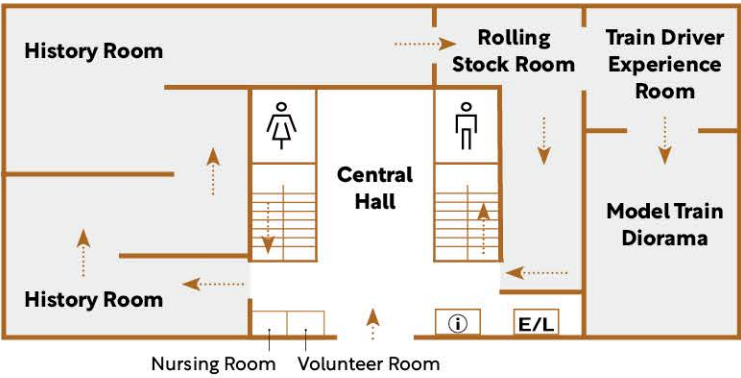

Central Hall
The Central Hall displays a photograph of the groundbreaking ceremony of the Gyeongin Railway, a cherished dream of the Korean Empire, along with a 1/5 scale model of the Pacific Class steam locomotive.



History Room
Here, visitors can witness the marks left by railway traffic over the 120 years since the beginning of Korea’s railway history on September 18, 1899



Rolling Stock Room
The Rolling Stock Room allows visitors to learn about the development of Korean railway vehicles, from steam locomotives to KTX trains, and the principles of train operation.



Train Driver Experience Room/Model Train Diorama
Visitors can experience operating electric trains and watch model trains in action in the railroad diorama room.

2F

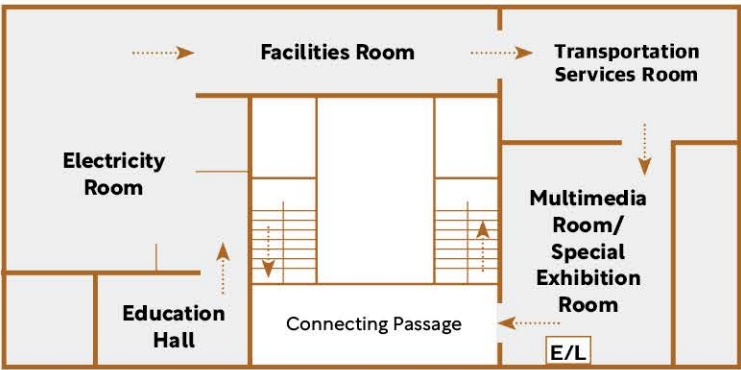

Electrical Room
This room introduces the advancements in railway electricity, signaling, and communication technologies that contribute to trains’ fast and safe operation.



Transportation Services Room
This room highlights the evolution of station and operation work for passenger and freight transport and introduces the joy of train travel.



Multimedia Room
The Video Experience Room showcases railway-related video content and hosts special exhibitions for a limited time.



Facilities Room
This room presents the composition and development process of railway structures such as tracks, stations, bridges, and tunnels.

KEY EXPERIENCE
PROGRAMS

Model Train Diorama
Observe models of major Korean trains in motion from the past to the present, sparking an interest in railroad history through an audiovisual display.

Operating Hours
Weekdays(2 sessions)
11:30, 14:00
Weekends and public holidays(3 sessions)
11:30, 13:30, 15:30

Train Driver Experience
Experience driving an electric train as a junior conductor.

Fee
500 KRW
Experience duration
Approximately 3 minutes

Railway Culture Guided Tour(in Korean)
A guided tour of the museum with explanations about the history and culture of the railways.

Operating Hours
Weekdays(2 sessions)
11:40, 14:10
Weekends and public holidays(4 sessions)
11:40, 12:40, 13:40, 14:40

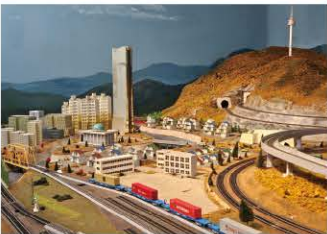

Railroad Museum



142 Cheoldobangmulgwan-ro, Uiwang-si, Gyeonggi-do, 16106(Woram-dong 374-1)
Phone 031-461-3610 Fax 031-460-4322 | <http://www.railroadmuseum.co.kr>

*Experience times are subject to change based on museum’s circumstances